



**Features:**

- Meets prescriptive requirements of CAN/CSA A370 for corrugated strip ties.
- Recommended in outdoor applications and with treated wood.

The new WT22B-HDG corrugated wall tie is designed to meet the prescriptive requirements of CAN/CSA-A370-14 for connecting a masonry veneer to a wood structural backing. The WT22B-HDG is hot-dip galvanized after being pre-bent and pre-punched for a #10 wood screw.

**Materials:** 22 gauge  
**Finish:** Hot-dip galvanized

**Installation:**

- The opposite end must be bonded in the mortar joint of brick facade.
- Use a minimum #10 wood screw to fasten to the wood structural backing.
- Wood screw shall penetrate at least 38 mm (1-1/2") into the wood structural backing.
- Check local codes for spacing requirements.

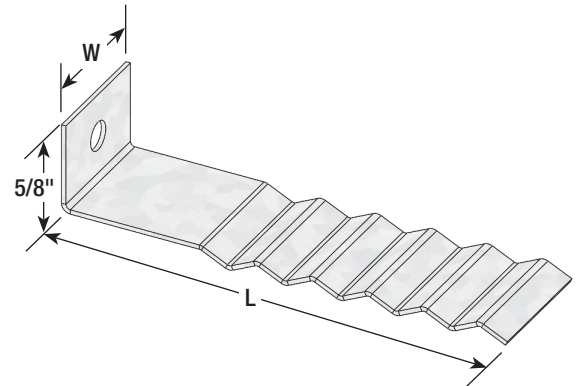

**WT22B-HDG**

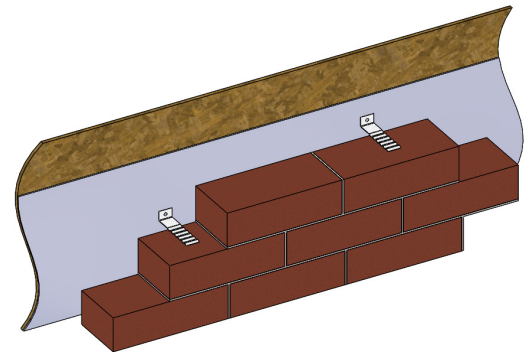

**Typical WT22B-HDG installation**

**USP supplies quality products to build Stronger Safer Structures**

**Customer Service:**

Tel: 1-855-633-2725  
Fax: 1-905-952-2903  
Email: mbp-orders@mittek.ca

[www.USPconnectors.com](http://www.USPconnectors.com)

USP Stock No.	Ref. No.	Steel Gauge	Dimensions (in)		Fastener Schedule		Ctn Qty
			W	L	Qty	Type	
WT22B-HDG	-- --	22	7/8	3-1/2	1	#10 HDG wood screw	500